

Wire Define

Pin 1 (black)	motor -
Pin 2 (red)	motor +
Pin 3 (grey)	hall GND
Pin 4 (brown)	hall +5~12V
Pin 5 (blue)	hall A
Pin 6 (orange)	hall B
Pin E (yellow/green)	Ground

Vertical Mounting Dimensions

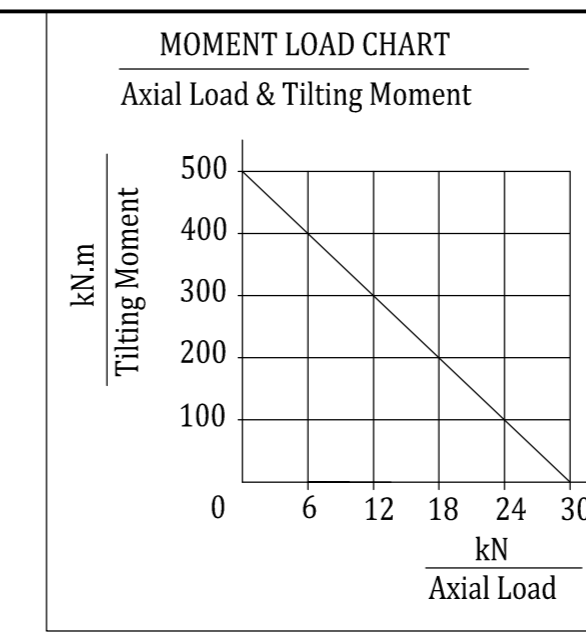
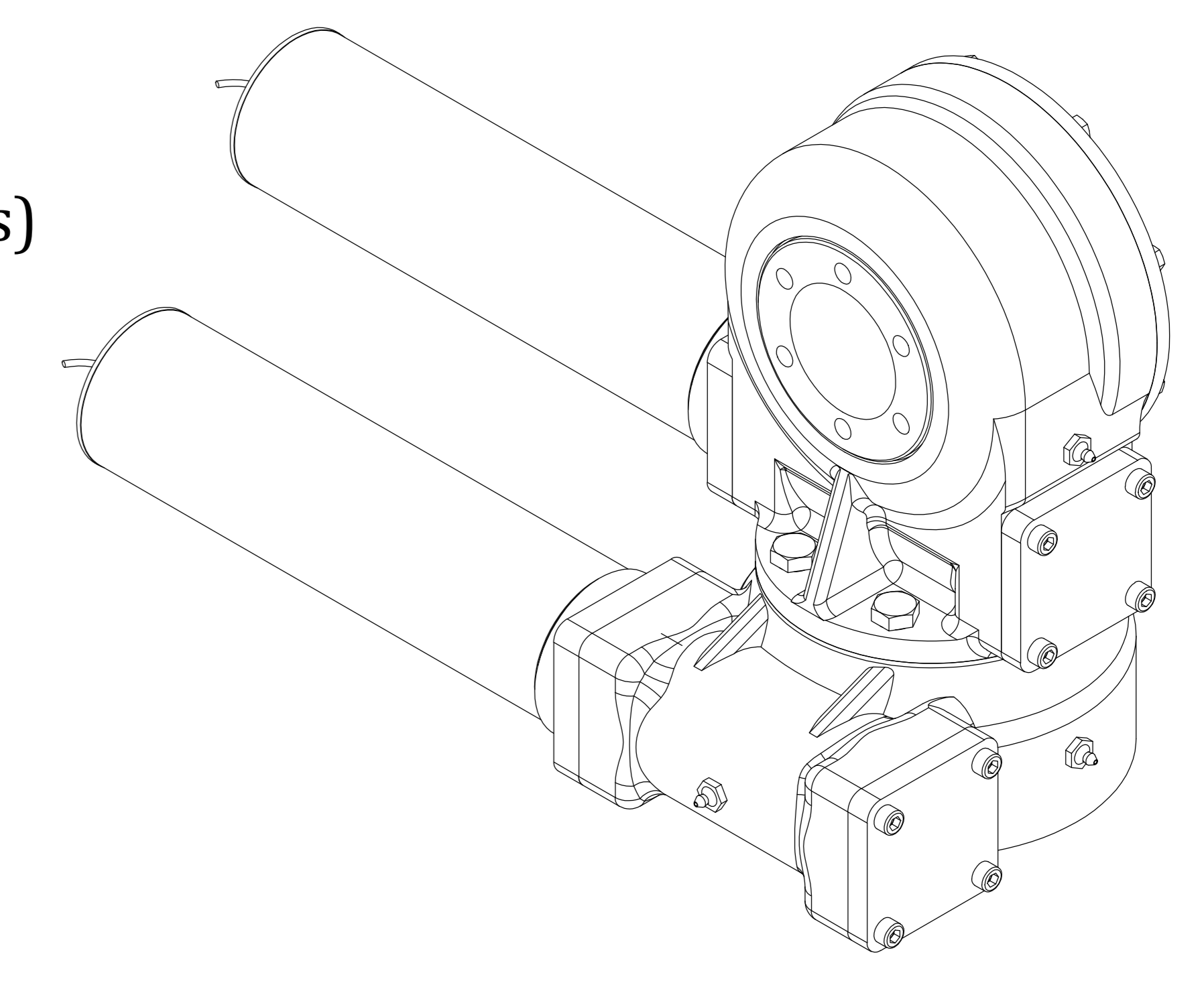
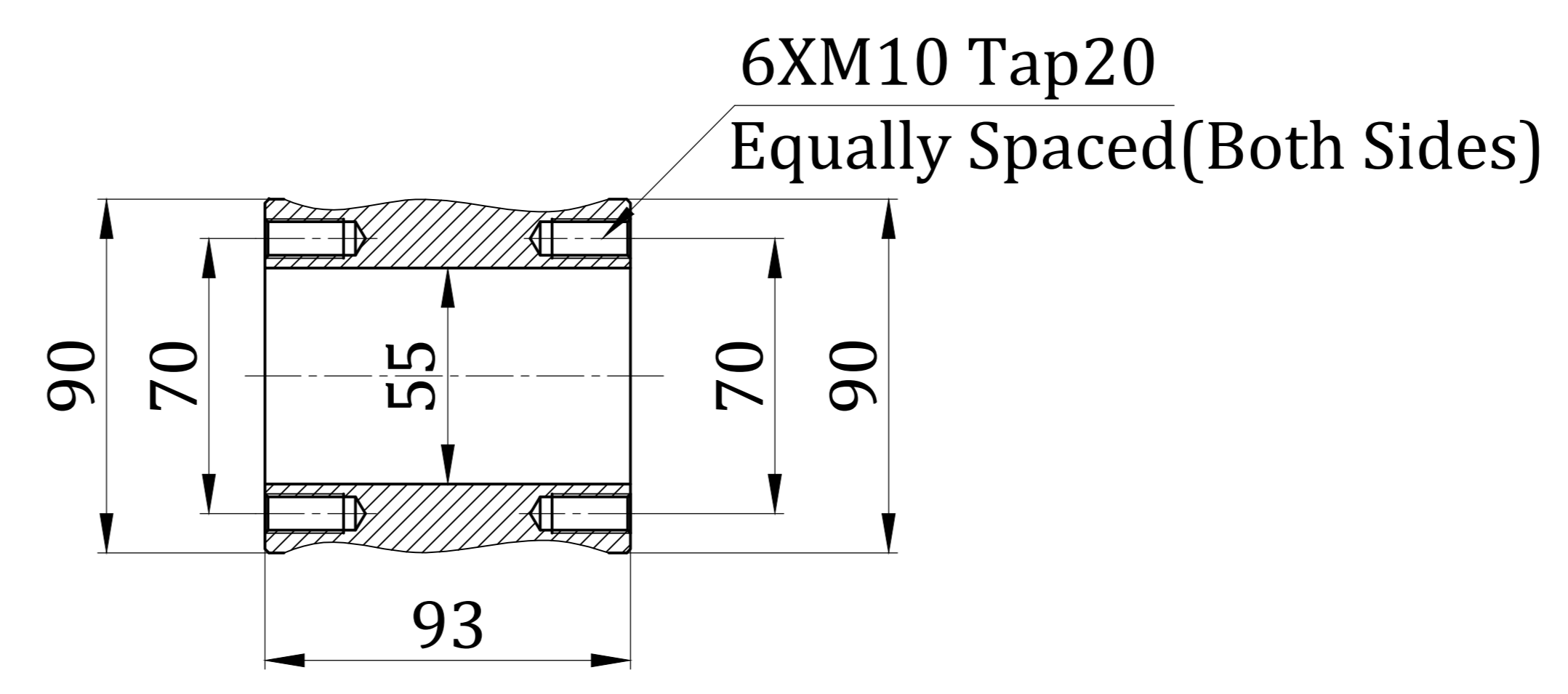

Slewing Drive Performance Parameters (Elevation direction)		
Rated Output Speed 0.048rpm		
Output Torque	716N.m	528 lbf.ft
Tilting Moment	1100 N.m	811 lbf.ft
Holding Torque	2200N.m	1479 lbf.ft
Static Axial Rating	30 kN	6750 lbf
Static Radial Rating	15 kN	3375 lbf
Dynamic Axial Rating	9.6 kN	2160 lbf
Dynamic Radial Rating	8.4 kN	1890 lbf
Gear Ratio	62:1	
Precision	±0.17°	

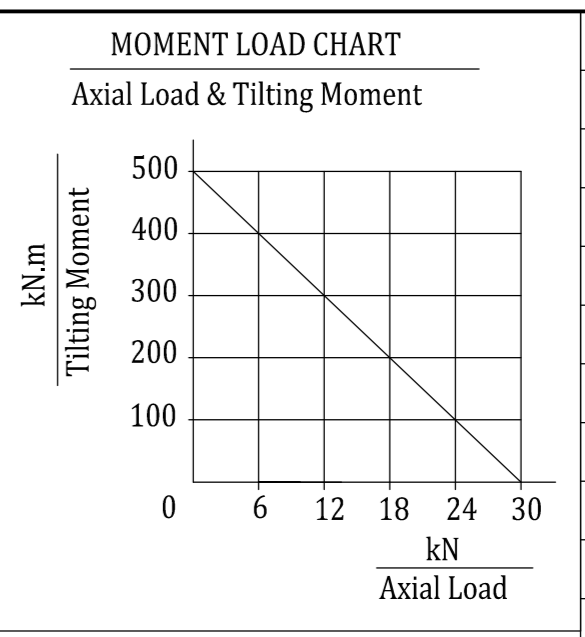

Slewing Drive Performance Parameters (Horizontal)		
Rated Output Speed 0.048rpm		
Output Torque	716N.m	528 lbf.ft
Tilting Moment	1100 N.m	811 lbf.ft
Holding Torque	2200N.m	1479 lbf.ft
Static Axial Rating	30 kN	6750 lbf
Static Radial Rating	15 kN	3375 lbf
Dynamic Axial Rating	9.6 kN	2160 lbf
Dynamic Radial Rating	8.4 kN	1890 lbf
Gear Ratio	62:1	
Precision	±0.17°	

24VDC Planetary Reducer Motor Performance Data (24H/30/33)		
Rated Output Torque	33 N.m	
Rated Output Speed	3 rpm	
IP Class	IP 65	
Gear Ratio	552:1	
Rated Current	<1.9 A	

24VDC Planetary Reducer Motor Performance Data (24H/30/33)		
Rated Output Torque	33 N.m	
Rated Output Speed	3 rpm	
IP Class	IP 65	
Gear Ratio	552:1	
Rated Current	<1.9 A	

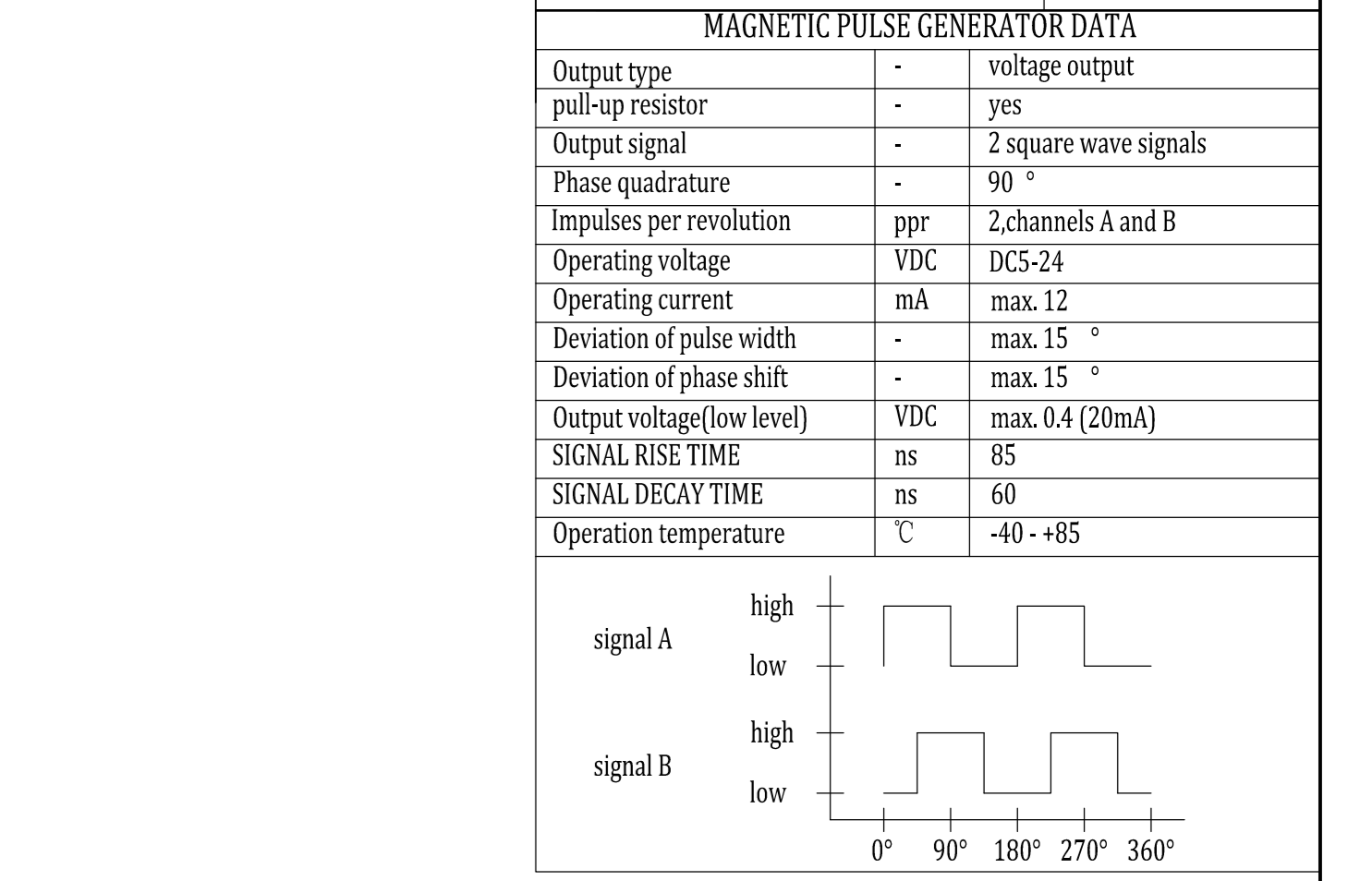
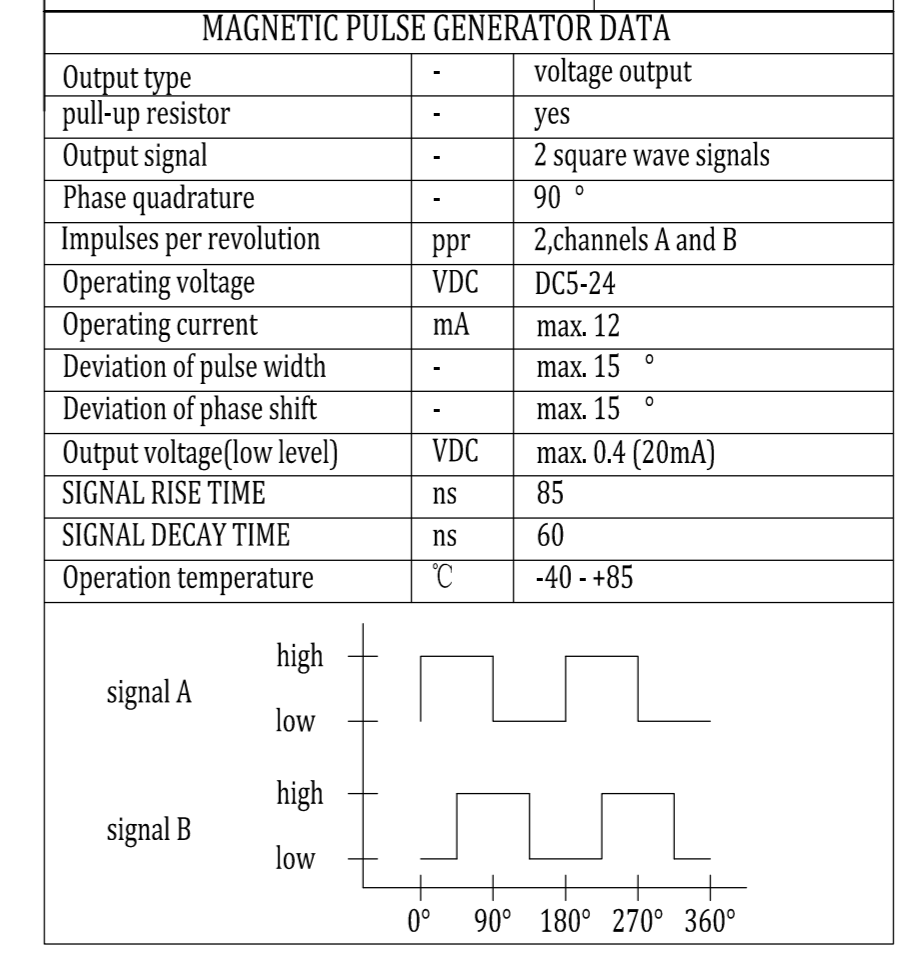

REV	DATE	REVISER	REVISER
DESIGNED BY	2022/4/26	Li Ming	www.coresundrive.com Coresun Drive Equipment Changzhou Co., Ltd.
CHECKED BY	2022/4/26	Rui Wang	
APPROVED BY	2022/4/26	Shane Zhang	
ALL PROPRIETARY RIGHTS IN THE SUBJECT MATTER HERE OF ARE RESERVED, AND NO PERMISSION IS GRANTED OR TO DISCLOSE REPRODUCE THIS PRINT IN WHOLE OR IN PART, ANY OF THE INFORMATION TO OTHERS.			
WEIGHT		SCALE	Slewing Drive
		1 : 3	
SIZE		A3	SVH3-62-RC-24H3033
SHEET		1 / 1	
SYMBOLS ISO			REV A